

NOTES: REF SPEC # CXWEC10K2

**CX-WEC10 EQUIPMENT PACKAGE:**

		SPEC REF
1	CM-AF540SO - 'PRESS FOR EMERGENCY ASSISTANCE' SWITCH & 'ASSISTANCE REQUESTED' LED ANNUNCIATOR WITH SOUNDER	2.2A-2A.1
2	CM-AF141SO - 'ASSISTANCE REQUIRED' SINGLE GANG DOME LIGHT WITH SOUNDER	2.2A-2A.1
3	CM-SE21A - EMERGENCY ASSISTANCE SIGN	2.2A-2A.1

**ADDITIONAL PARTS REQUIRED BUT NOT INCLUDED WITH THE CX-WEC10:**

4	CX-PS13 - 12/24 VDC LINEAR POWER SUPPLY	2.2B-2B.1
5	CX-TRX-4024 - 40VA, 24 VAC TRANSFORMER	2.2B-2B.1

**NOTE:**  
WHEN USED WITH A CAMDEN CX-WC SERIES BARRIER WASHROOM KIT, THE CX-WEC10K2 CAN GET ITS POWER FROM THE BARRIER FREE WASHROOM KITS POWER SUPPLY.

**SYSTEM OPERATION**

**CX-WEC10 OPERATION:**

1. THE 'PRESS FOR EMERGENCY ASSISTANCE' MUSHROOM PUSH BUTTON IS ACTIVATED BY THE OCCUPANT.
2. THIS ENERGIZES THE LED ANNUNCIATOR AND SOUNDER WITHIN THE WASHROOM, AND THE DOME LIGHT WITH SOUNDER OUTSIDE THE WASHROOM.
3. BOTH ANNUNCIATORS WILL BE ENERGIZED UNTIL THE LATCHING MUSHROOM PUSH BUTTON SWITCH IS PULLED OUT.

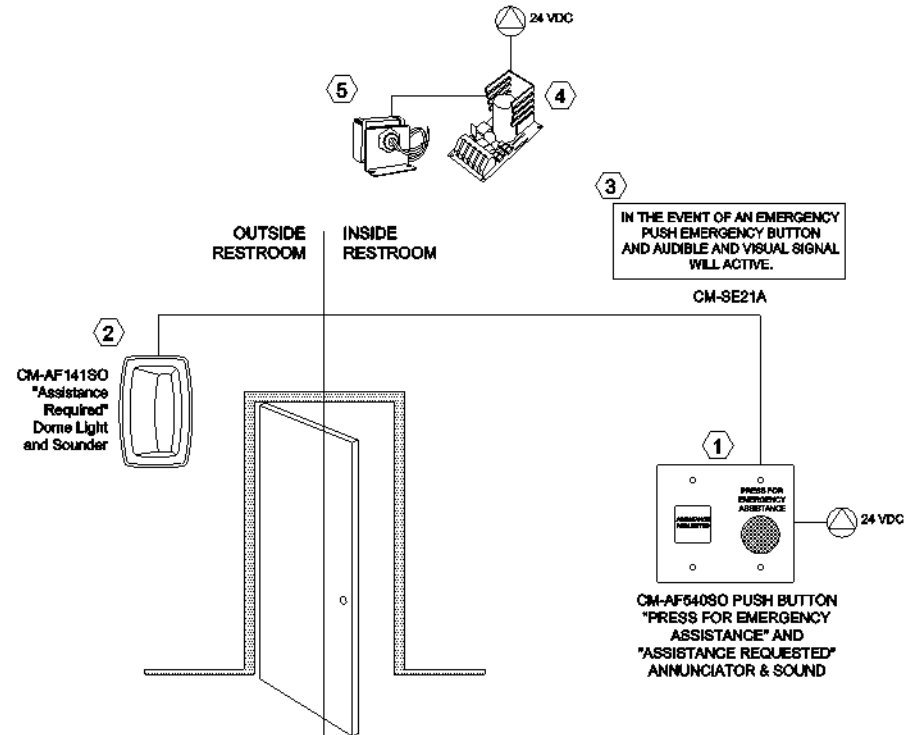

5502 Timberlea Blvd.  
Mississauga, ON Canada L4W 2T7  
Tel: (905) 366-3377  
www.camdencontrols.com

	NAME	DATE	TITLE:						
DRAWN	J.LEWIS	MAR-17	EMERGENCY CALL SYSTEMS FOR UNIVERSAL RESTROOMS (CX-WEC10K2)						
CHECKED									
ENG APPR.									
MFG APPR.									
D.A.									
COMMENTS:			<table border="1"> <tr> <td>SIZE</td> <td>DWG. NO.</td> <td>REV</td> </tr> <tr> <td>B</td> <td>CX-WEC10K2_R2.DWG</td> <td>2</td> </tr> </table>	SIZE	DWG. NO.	REV	B	CX-WEC10K2_R2.DWG	2
SIZE	DWG. NO.	REV							
B	CX-WEC10K2_R2.DWG	2							
SCALE: N/A		SHEET 1 OF 1							