

CX-WEC10K2 EQUIPMENT PACKAGE:

- 1 CM-AF540SO - 'PRESS FOR EMERGENCY ASSISTANCE' SWITCH & 'ASSISTANCE REQUESTED' LED ANNUNCIATOR WITH SOUNDER
- 2 CM-AF141SO - 'ASSISTANCE REQUIRED' SINGLE GANG LED DOME LIGHT WITH SOUNDER
- 3 CM-SE21A - EMERGENCY ASSISTANCE SIGN

ADDITIONAL PARTS REQUIRED BUT NOT INCLUDED WITH THE CX-WEC10BK2:

- 4 CX-PS13 - 12/24 VDC LINEAR POWER SUPPLY
- 5 CX-TRX-4024 - 40VA, 24 VAC TRANSFORMER

NOTE:
WHEN USED WITH A CAMDEN CX-WC SERIES BARRIER WASHROOM KIT, THE CX-WEC10K2 CAN GET ITS POWER FROM THE BARRIER FREE WASHROOM KITS POWER SUPPLY.

SYSTEM OPERATION

CX-WEC10K2 OPERATION:

- A. THE 'PRESS FOR EMERGENCY ASSISTANCE' MUSHROOM PUSH BUTTON IS ACTIVATED BY THE OCCUPANT.
- B. THIS ENERGIZES THE LED ANNUNCIATOR AND SOUNDER WITHIN THE WASHROOM, AND THE DOME LIGHT WITH SOUNDER OUTSIDE THE WASHROOM.
- C. BOTH ANNUNCIATORS WILL BE ENERGIZED UNTIL THE LATCHING MUSHROOM PUSH BUTTON SWITCH IS PULLED OUT.

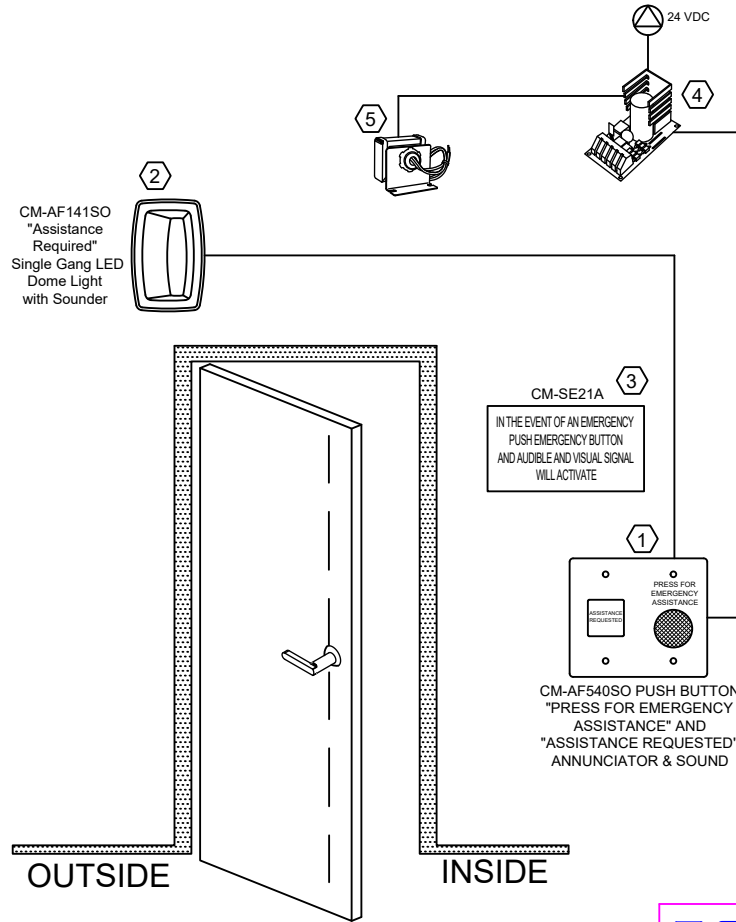

		5502 Timberlea Blvd. Mississauga, ON Canada L4W 2T7 Tel: (905) 366-3377 www.camdencontrols.com			
		TITLE: EMERGENCY CALL SYSTEMS WITH MULTI-COLOR DOME LIGHT FOR UNIVERSAL RESTROOMS (CX-WEC10K2)			
DRAWN A.OLISA	NAME A.OLISA	DATE APR-20	SIZE B	DWG. NO. CX-WEC10K2_Cad.DWG	REV 1
COMMENTS:		SCALE: N/A	SHEET 1 OF 1		